

# Industrial Space Available

Move Your Business **closer** to the Port of NY & NJ

2075 91st Street, North Bergen, New Jersey

Close to Manhattan

**Warehouse Space Available: 16,045 SF**

**Location:** 2075 91st Street  
North Bergen, NJ

**Space Available:** 16,045 square feet

**Rental:** Upon Request

**Possession:** Immediate

**Term:** 5 year minimum

**Floor Load (Warehouse):** 250 lbs psf

**Clear Ceiling Height:** 24'-2"

**Column Spacing:** 48'-2" by 42'-2"

**Loading Docks:**

Two (2) 8' x 8'  
One (1) Overhead Door

**Comments:**

- Excellent distribution facilities with access to all major truck routes.
- Prime industrial building located off Route 1 & 9. The building is within minutes of Manhattan and Newark International Airport. The Garden State Parkway, Routes 17, 46, 1 & 9, and arteries to I-80, I-95 and I-280, the Lincoln Tunnel and George Washington Bridge are easily accessible.

**Economic Incentives:**

- The building is within the UEZ.

*For leasing information, please contact:*

**Charlie Reese** • 201-272-5202  
[charlie.reese@hartzmountain.com](mailto:charlie.reese@hartzmountain.com)

**Rick Vanderbeck** • 201-272-5223  
[rick.vanderbeck@hartzmountain.com](mailto:rick.vanderbeck@hartzmountain.com)

**Stephen Benoit** • 201-272-5214  
[stephen.benoit@hartzmountain.com](mailto:stephen.benoit@hartzmountain.com)

**Hartz Mountain Industries, Inc.**

Leasing Department

500 Plaza Drive, Secaucus, NJ 07096-1515

201.348.1200 - Phone • 201.348.4358 - Fax

[HartzMountain.com](http://HartzMountain.com)



**URBAN ENTERPRISE ZONE**

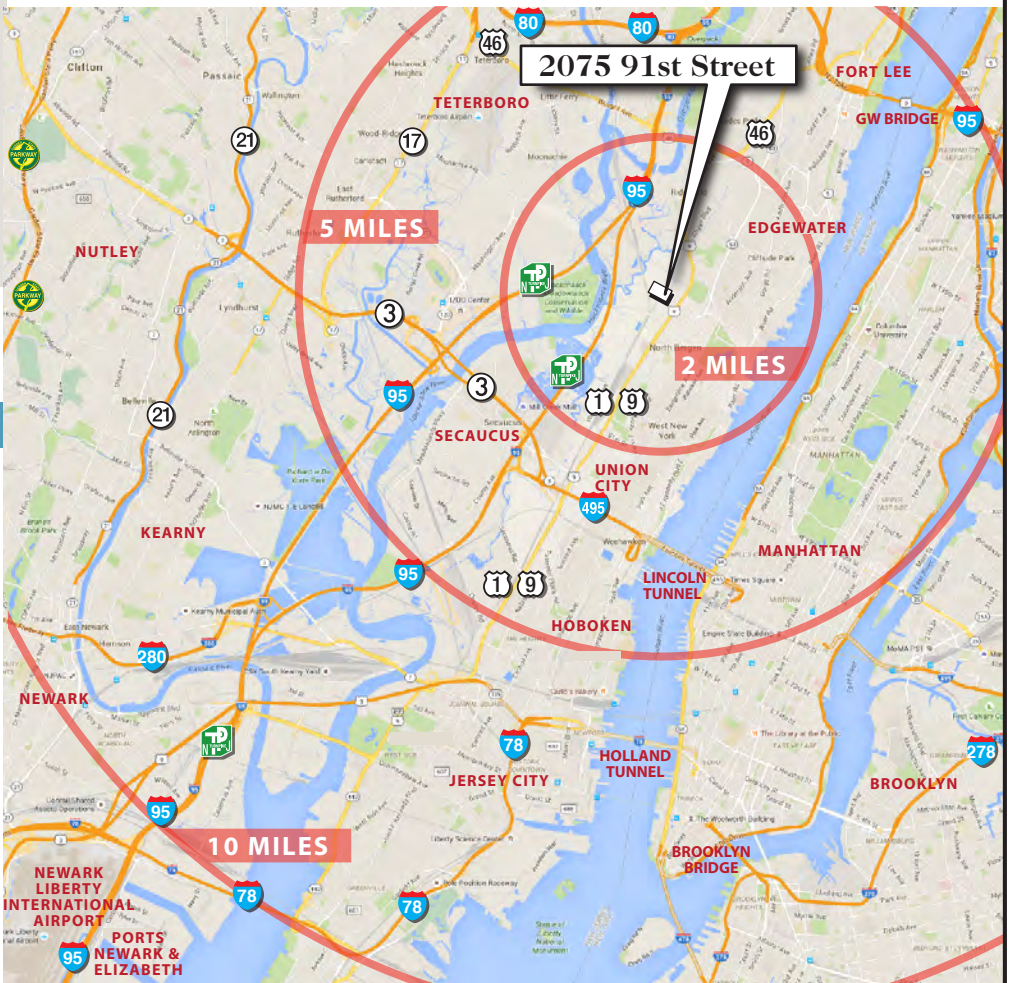

# Industrial Space Available

Move Your Business **closer** to the Port of NY & NJ

2075 91st Street, North Bergen, New Jersey



2 DOORS - 8' x 8'

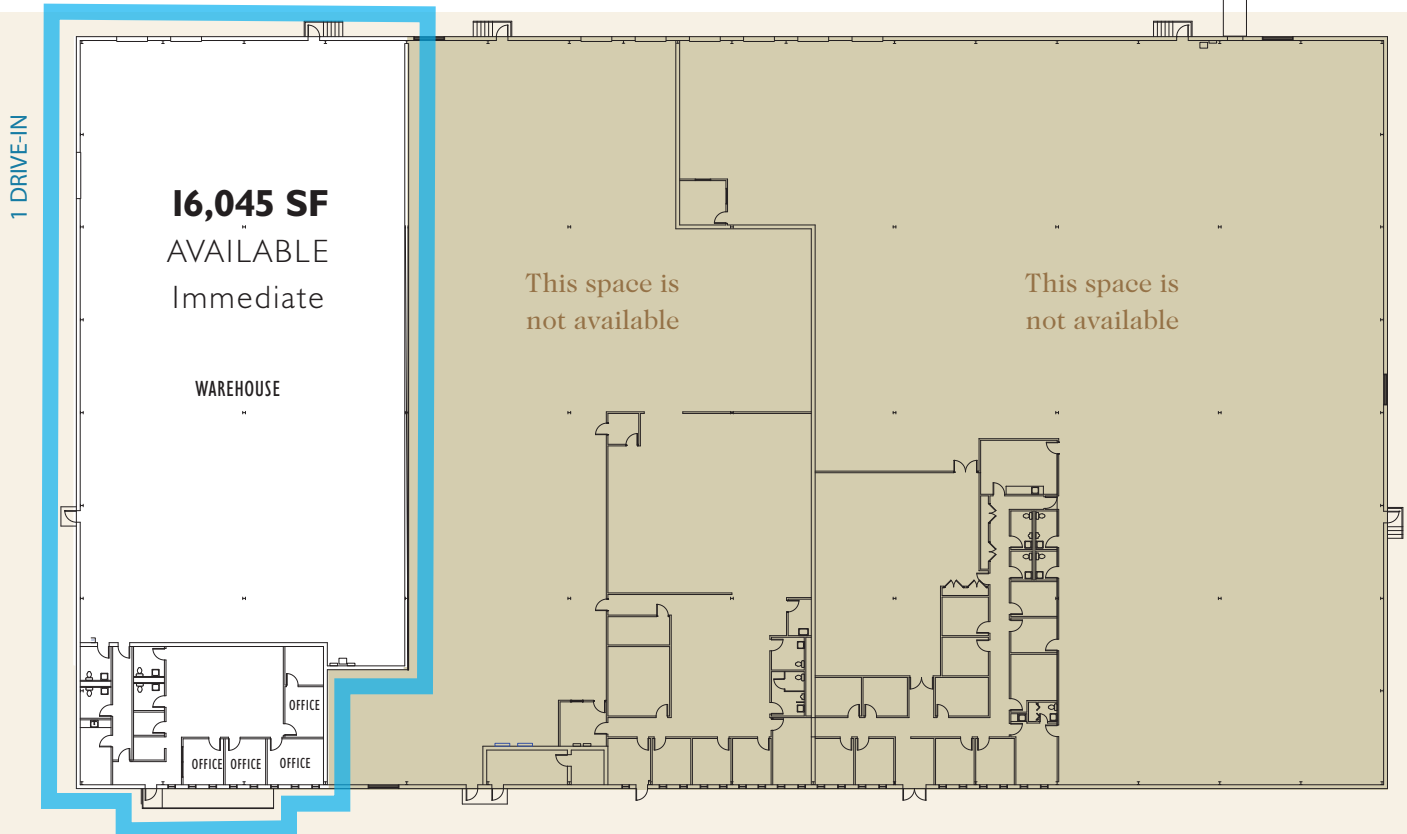

For leasing information, please contact:

**Charlie Reese** • 201-272-5202  
[charlie.reese@hartzmountain.com](mailto:charlie.reese@hartzmountain.com)

**Rick Vanderbeck** • 201-272-5223  
[rick.vanderbeck@hartzmountain.com](mailto:rick.vanderbeck@hartzmountain.com)

**Stephen Benoit** • 201-272-5214  
[stephen.benoit@hartzmountain.com](mailto:stephen.benoit@hartzmountain.com)