



DONALD LEE HOLLOWELL PARKWAY

3495 Donald Lee Hollowell Parkway, Suite 116
Atlanta, GA

**FOR LEASE
30,800 SF**

Partnership. Performance.

Property Highlights

Available Space:	30,800 SF
Office Space:	800 SF
Total Bldg Size:	286,400 SF
Clear Height:	30'
Bay Size:	40' X 50'
Doors:	5 (8'x 10') DH – 2 Rail Doors
Sprinkler:	Yes

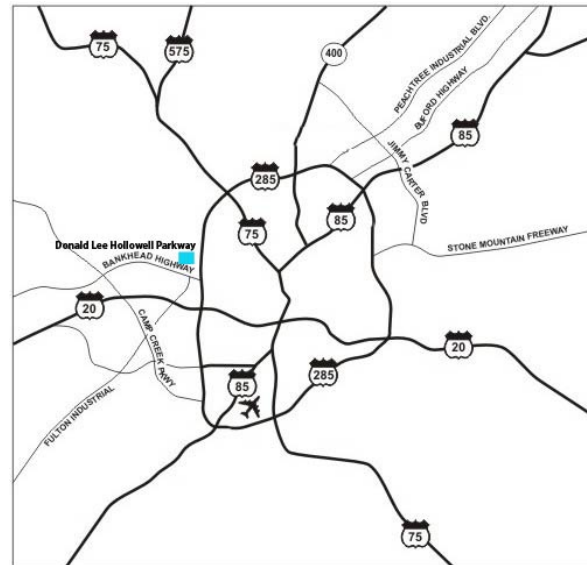

Partnership. Performance.

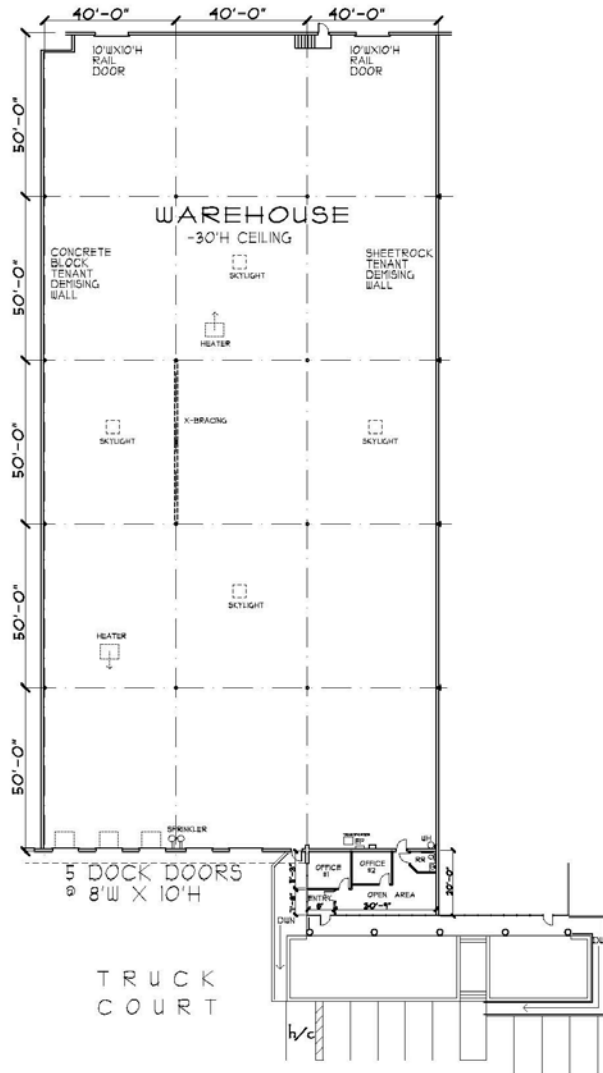

For Additional Information,
Please Contact:

TOM CROWE
Principal
770.916.6160
Tom.Crowe@avisonyoung.com