

Industrial Warehouse Space Available

Move Your Business **closer** to the Port of NY & NJ

114-120 Seaview Drive, Secaucus, New Jersey

Available January 1, 2023

69,982 SF

7,651 SF MEZZANINE OFFICE



- Floor Load (Warehouse): 250 lbs psf
- Column Spacing: 45' x 40'
- Electric Service: 1,000 amps, 265/460V, 4-wire, 3-phase
- Six (6) Exterior Loading Docks
- Ceiling Height: 24'

Comments:

- Industrial building located directly off NJ Turnpike at Exit 15X. 2-1/2 miles to the Lincoln Tunnel. The building is within minutes of the Ports, Newark Liberty International Airport and Teterboro Airport. The Garden State Parkway, Routes 17, 46, and arteries to I-80 are easily accessible.

Economic Incentives:

- The New Jersey Economic Development Authority (EDA) offers a multitude of incentive programs.



Visit www.njeda.com for more info.

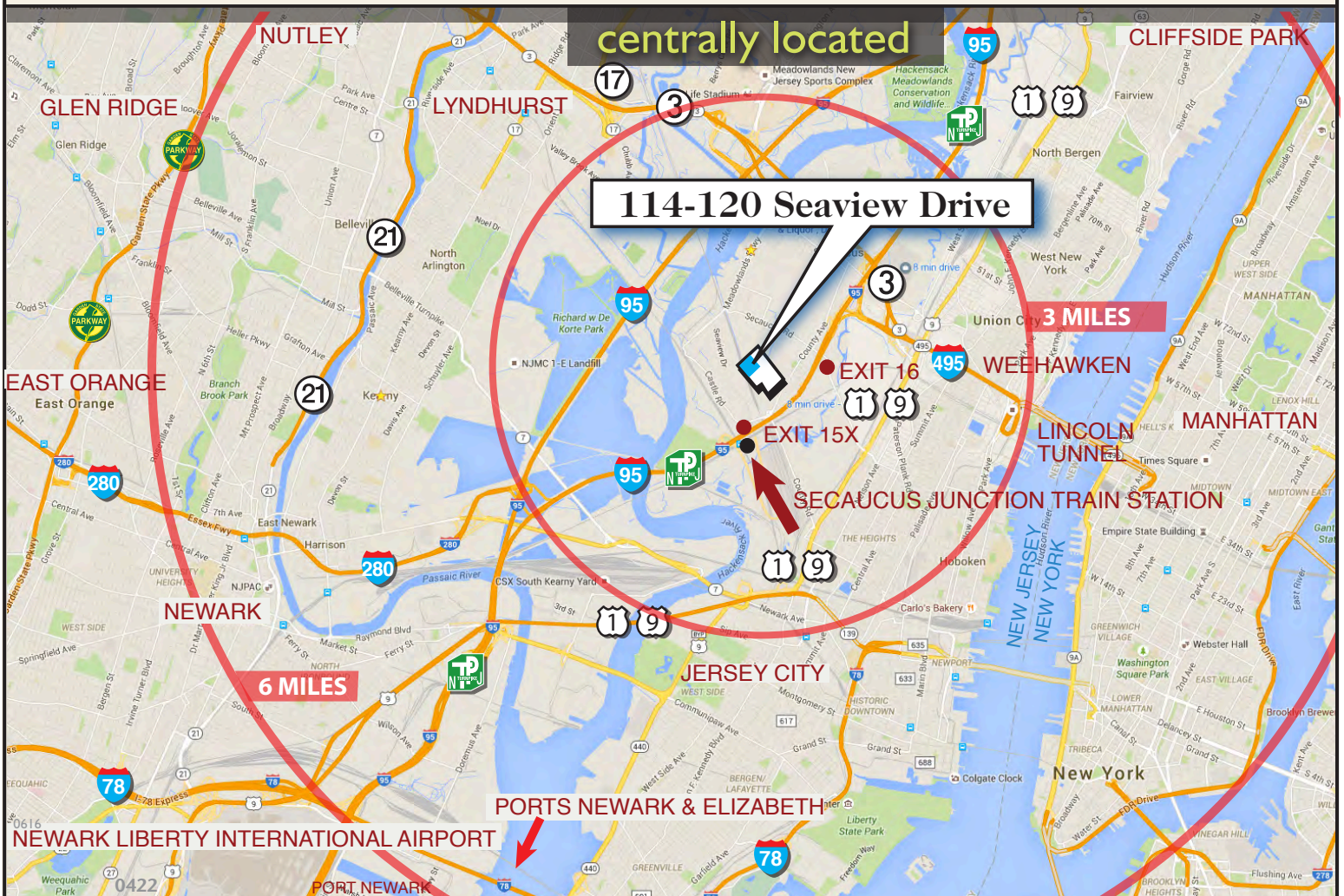

**Industrial Warehouse
Space Available**

Move Your Business **closer** to the Port of NY & NJ

114-120 Seaview Drive, Secaucus, New Jersey

Available January 1, 2023

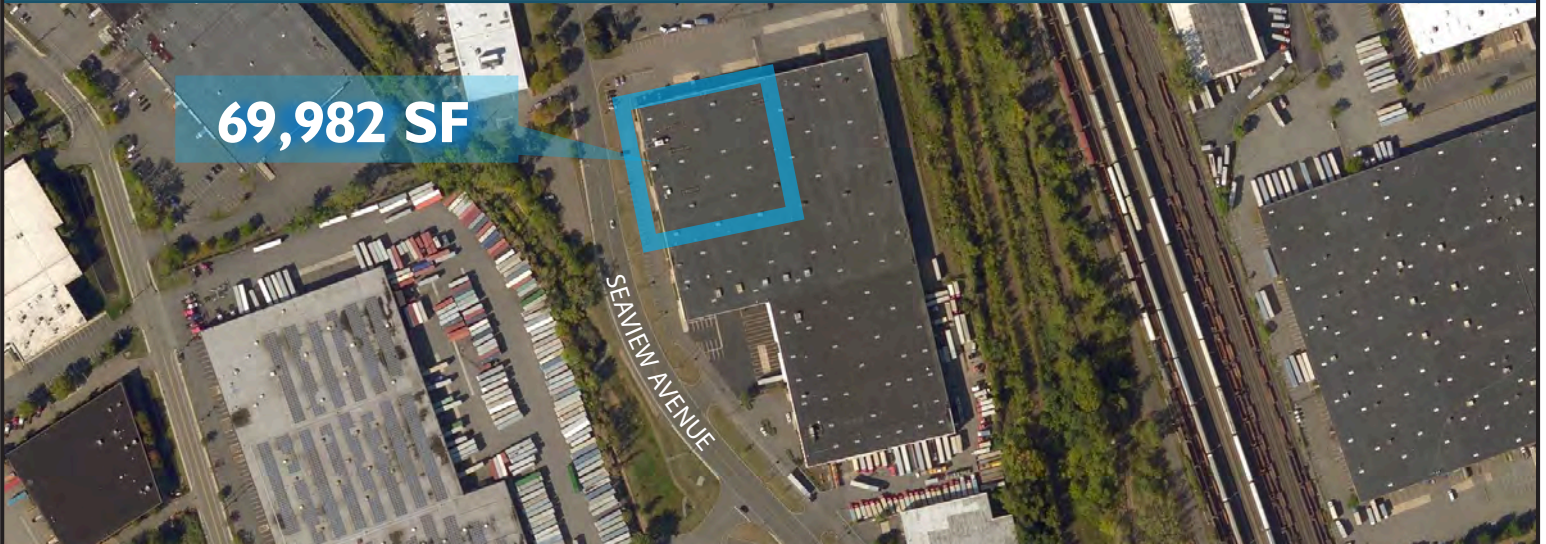

69,982 SF

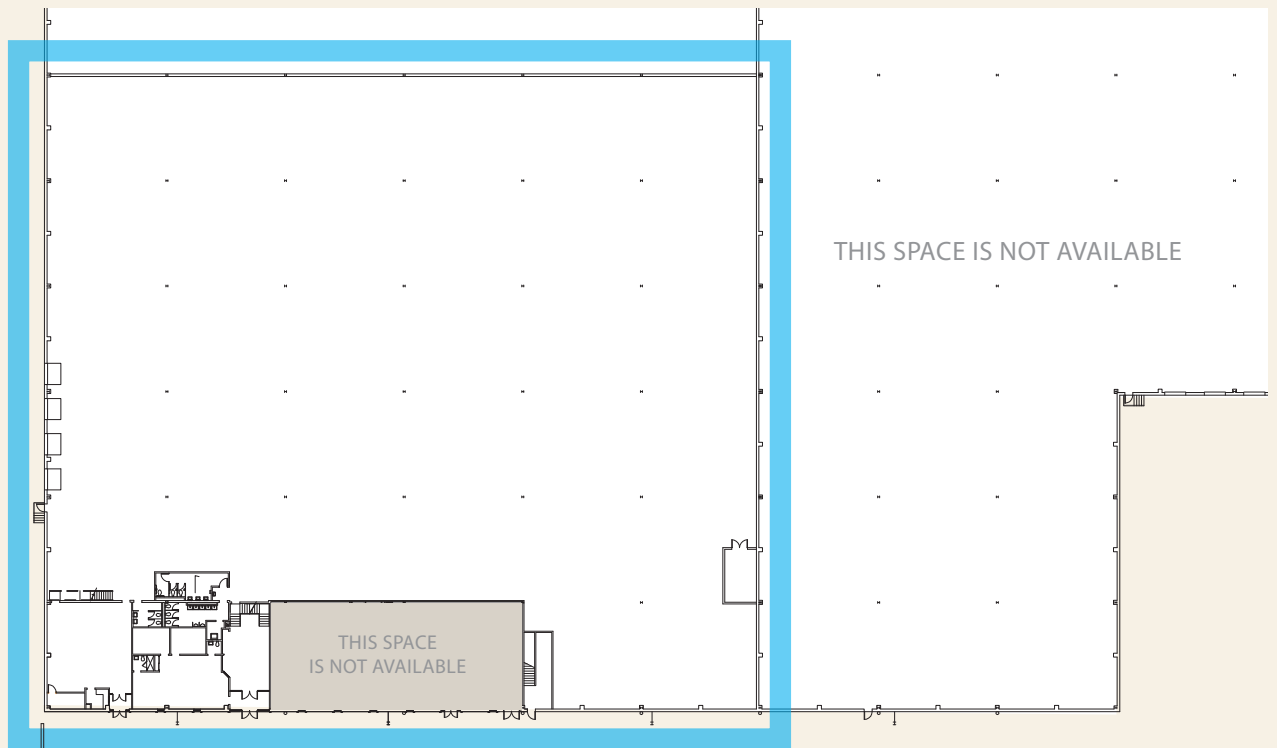

**Mezzanine Office
7,651 SF**

1/2 MILE TO NJ TURNPIKE →
SEAVIEW DRIVE

For leasing information, please contact:

Charlie Reese • 201-272-5202
charlie.reese@hartzmountain.com

Rick Vanderbeck • 201-272-5223
rick.vanderbeck@hartzmountain.com

Stephen Benoit • 201-272-5214
stephen.benoit@hartzmountain.com