

1200 HARBOR BLVD
Weehawken, New Jersey



9TH FLOOR PLAN

35,340 SF

Terms Upon Request



VIEW OF THE PALISADES

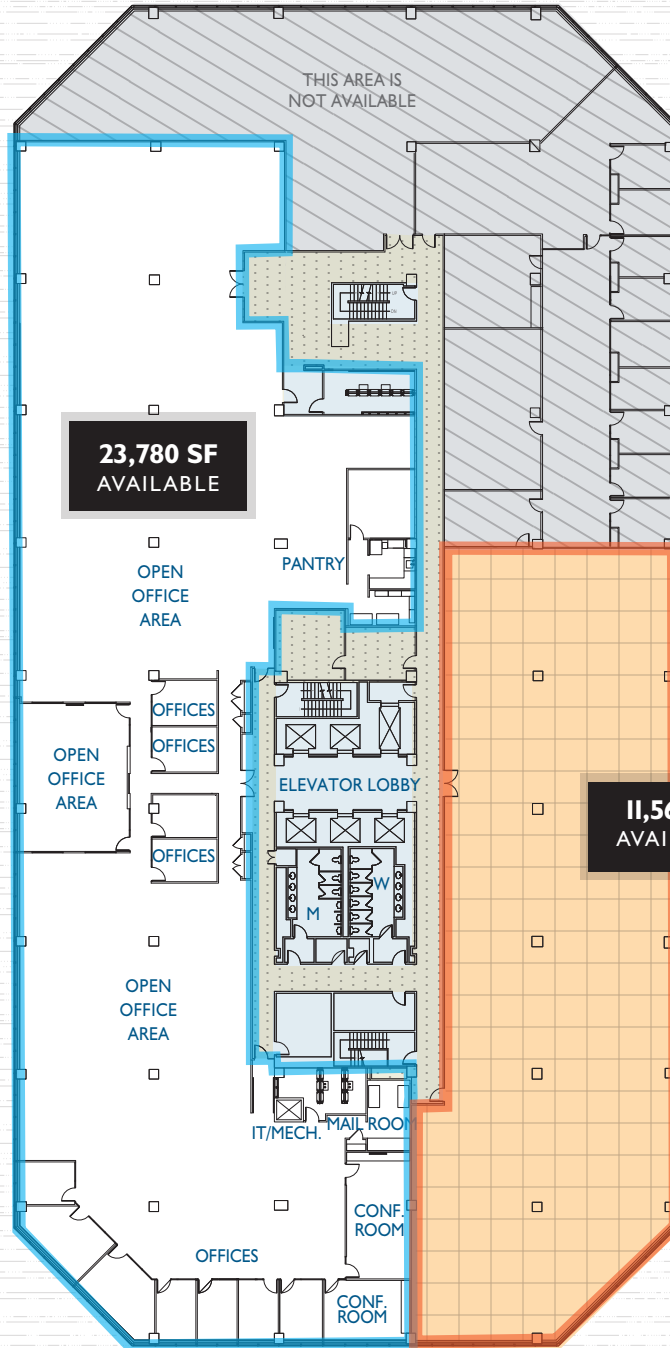

9th FLOOR



Space Available:

- Third Floor:** 34,104 SF
- Fourth Floor:** 43,663 SF
- Eighth Floor:** 34,420 SF & 13,956 SF
- Ninth Floor:** 23,780 SF & 11,560 SF
- Tenth Floor:** 23,270 SF & 4,742 SF
- Total:** 189,495 SF

Rental: Upon Request

Possession: Immediate

Term: 5 years minimum

Structure: Steel Frame

Exterior: Insulated glass curtain wall in thermal break system

Floor-to-Floor Heights: 13'-9"

Clear Ceiling Heights: 9'-0"

Floor Load: 100 LBS PSF

HVAC: Cooling tower, chiller, hot water baseboard, heat exchangers, VAV.

Fire Protection:

Fully sprinklered, manual pull stations to activate voice evacuation system, automatic smoke alarm.

Elevators:

Five (5) Passenger
One (1) Freight

Fiber:

Multiple fiber providers are available, including Optimum, Verizon and ATT.

Electrical:

Primary service 13.2 KV from PSE&G.

VIEWS OF
MANHATTAN

HUDSON RIVER

VIEW OF THE
GEORGE
WASHINGTON
BRIDGE

For further information or to schedule an inspection contact:

Charlie Reese • 201-272-5202
charlie.reese@hartzmountain.com

Stephen Benoit • 201-272-5214
stephen.benoit@hartzmountain.com



HARTZ

A Hartz Mountain Property